

SPECIFICATIONS

CONTACT RATING: Dependent upon contact material.

MECHANICAL LIFE: 30,000 make-and-break cycles.

CONTACT RESISTANCE: 20mΩ max. initial @ 2-4VDC

100mA for both silver and gold plated contacts.

INSULATION RESISTANCE: 1,000MΩ min.

DIELECTRIC STRENGTH: 1,000 V RMS@sea level.

OPERATING TEMPERATURE: -30°C to 85°C.

MATERIALS

CASE: Diallyl phthalate (DAP) (UL94v-0).

HOUSING: Brass,tin plated.

ACTUATOR: Nylon,black.

CONTACT: Silver or gold plated.

TERMINAL SEAL: Copper alloy,with silver and gold plated .

(See Page 97)

HOW TO ORDER

MODEL NO. ACTUATOR TERMINATIONS CONTACT MATERIAL SEAL ROHS SOLDERING



MODEL NO.

- 5FS1 SP On-None-On
- 5FS2 SP On-None-Mom
- 5FS3 SP On-Off-On
- 5FD1 DP On-None-On
- 5FD3 DP On-Off -On

ACTUATOR
S1 3.10 high

TERMINATIONS

- M2 PC thru-hole
- M5 Wire wrap
- M6 Right angle, PC thru-hole
- M6N Right angle, snap-in, PC thru-hole
- M7 Vertical right angle, PC thru-hole
- MT (STD) Right angle, surface mount.

CONTACT MATERIAL

- Q Silver
- R Gold
- G Gold,pure-tin
- S Silver,pure-tin
- C Gold over silver
- K Gold over silver,pure-tin

SEAL

- E EPOXY (std)
- N NO EPOXY

- RoHS Compliant
- S RoHS & Lead Free

SWITCH FUNCTION

NO. POLES	UL/CSA MODEL NO.	MODEL NO.	SWITCH FUNCTION			CONNECTED TERMINALS / SCHEMATIC		
			POS.1	POS.2	POS.3	POS.1	POS.2	POS.3
SP	Q2511	5FS1	ON	NONE	ON	2-1	N/A	2-3
	Q2513	5FS3	ON	OFF	ON	2 (COMM) 1 • 3	OPEN	2 (COMM) 1 • 3
DP	Q2521	5FD1	ON	NONE	ON	2-1,5-4	N/A	2-3,5-6
	Q2523	5FD3	ON	OFF	ON	2 (COMM) 5 1 • 3 4 • 6	OPEN	2 (COMM) 5 1 • 3 4 • 6

MOM=MOMENTARY

POLE OPTIONS



SPDT

Part No. Shown : 5FS1S102M2QE

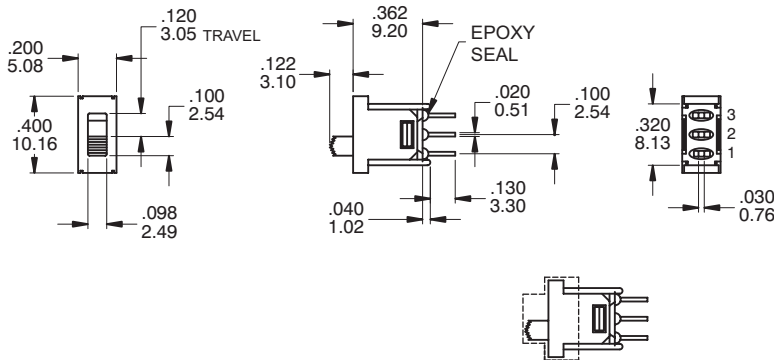

Waterproof transparent cover

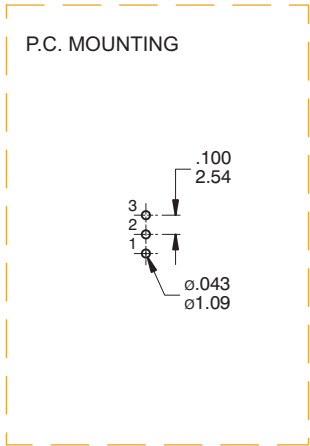

DPDT

Part No. Shown : 5FD1S102M2QE

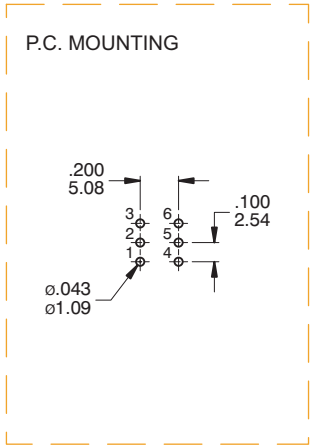
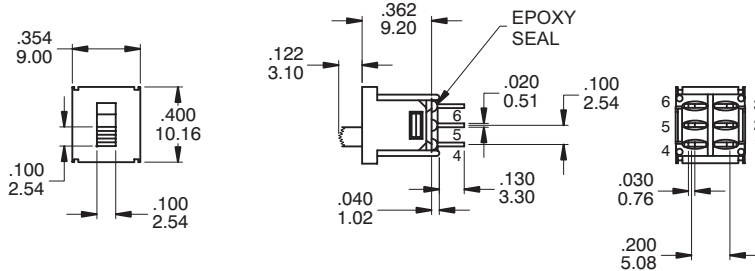

TERMINATION OPTIONS

M2 PC THRU-HOLE

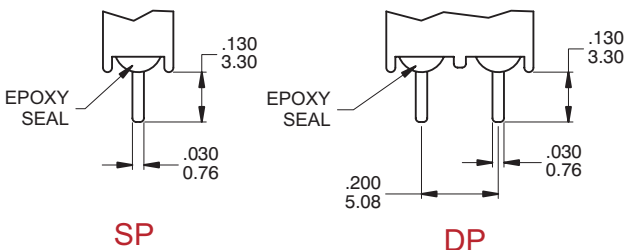

OTHER TERMINATION OPTIONS	
M6	RIGHT ANGLE P.C. MOUNT
M6N	SNAP - IN RIGHT ANGLE P.C. MOUNT

Slide Switches

Sub-Miniature Slide Switches **5F SERIES**

M6

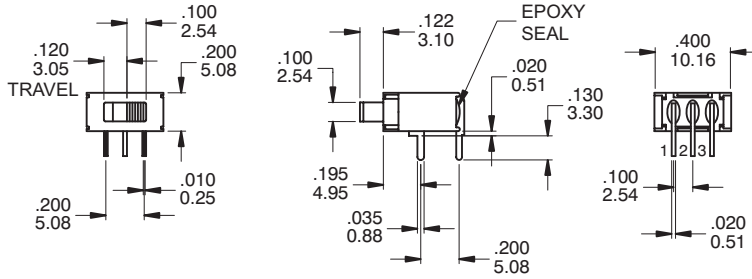
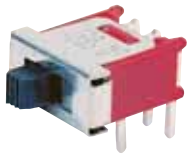

P.C. MOUNTING

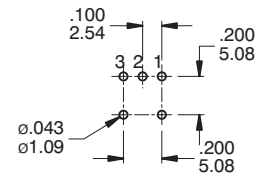

SPDT

Part No. Shown : 5FS1S102M6QE

M6

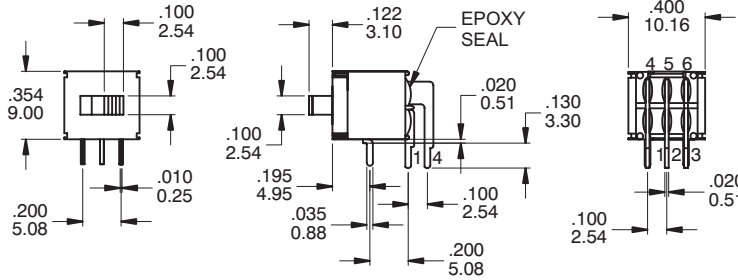
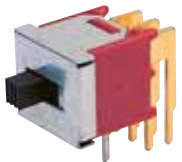

P.C. MOUNTING

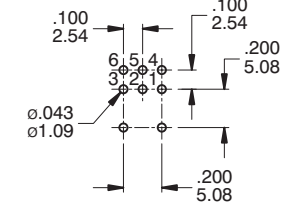

DPDT

Part No. Shown : 5FD1S102M6QE

MZ

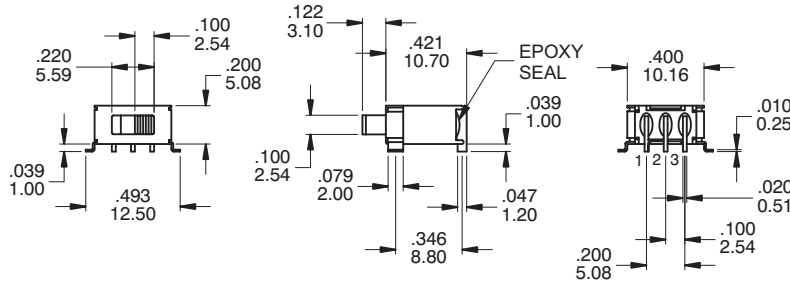

P.C. MOUNTING

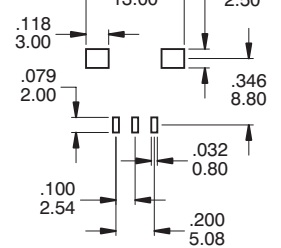

SPDT

Part No. Shown : 5FS1S102MZRES

M7N

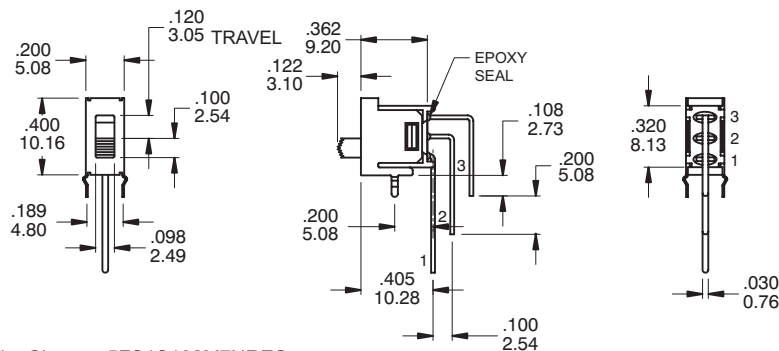

P.C. MOUNTING

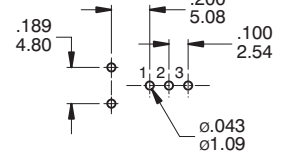

SPDT

Part No. Shown : 5FS1S102M7NRES

SNAP-IN TERMINATION OPTIONS

M6N

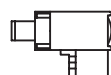

CONTACT MATERIAL OPTIONS

	CONTACT MATERIAL	TERMINAL PLATING	RATINGS
Q	Silver	Q = Silver	3 Amps with resistant load @ 120VAC or 28VDC 1 Amps with resistant load @ 250VA
S		S = Silver,pure - tin	
C	Gold over Silver	C = Gold over silver	
K		K = Gold over silver,pure - tin	
R	Gold	R = Gold	0.4 Volt - Amps (VA) max. @ 20V max. (AC or DC)
G		G = Gold,pure - tin	



SOLDERING PROCESSES

MANUAL SOLDERING : Use soldering iron of 30 watts, controlled st 350°C approximately 5 seconds while applying solder.

WAVE SOLDERING : Recommended Soldering Temperature : 260 ± 5°C
Duration of Solder Immersion : 5 ± 1 seconds
(PCB is 1.6mm in thickness)

SOLDERING : Vapor phase

